

## Student login and password

### USERNAME:

Your student's login is the last two numbers of their graduation year plus their last name and first letter of their first name.

For example: Jason **Smith** who is graduating in **2022** their login would be **22SmithJ**

### EMAIL:

Some programs require just a username like the example above. However, some require your full email address. That simply means adding @lynden.wednet.edu to the end. In the example above it would be [22SmithJ@Lynden.wednet.edu](mailto:22SmithJ@Lynden.wednet.edu)

### PASSWORD:

Your student's password will consist of a L plus their Student ID number plus an exclamation mark !.

For example: It could look like L435654332!

If you are having a problem with your login and password please try with a username and a full email address before you contact your school's Tech Coach.

## Using Devices for students in 6-12

When the laptop is turned on it will come to a Terms of Use screen. Please click "Ok" and the computer will go to a login screen which will require students to login using a generic login and password.

### For High School student:

The login is: **Laptoploan**

The password is: **Lions!**





Once your device is on please be sure to connect your device to an available WiFi connection.

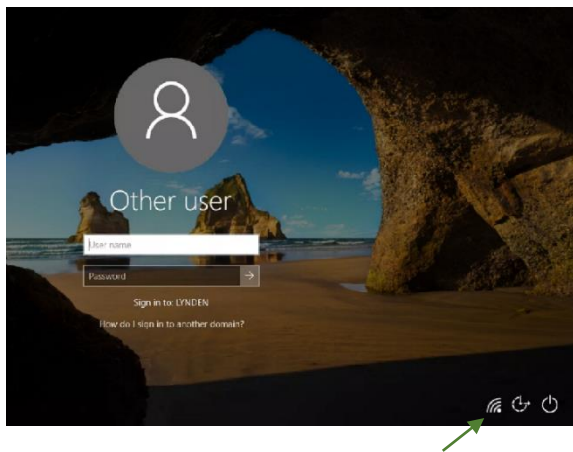

**Click on the WiFi icon in the bottom right of your screen.**

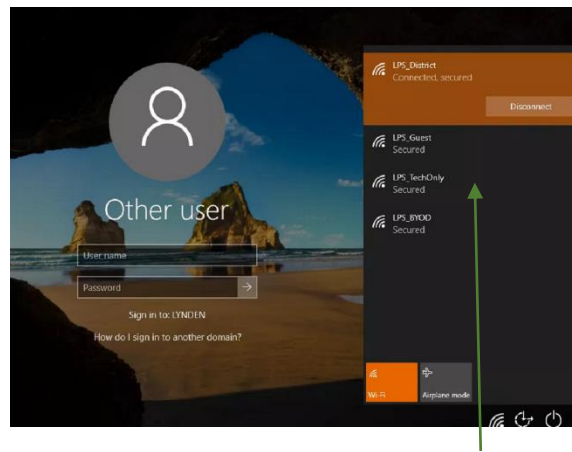

**Find your WiFi network and login.**

If you have trouble connecting your device to WiFi at home please consult your internet provider.

After establishing a working WiFi connection please proceed to the next step below.



Before using the online tools please open a web browser (Chrome or Edge, both found on your desktop). You will be required to login to Content Keeper first before surfing the internet or using any browser-based tools.



HELP

  
ContentKeeper  
Proven Internet Security for the Enterprise

bombere

.....

LOGIN

ContentKeeper.com

By logging into this system, the user is asserting that they are authorized to do so and acknowledging that any such usage is strictly in accordance with the terms and conditions of the ContentKeeper Software License Agreement.

Copyright © 2000 - 2020, ContentKeeper Technologies

Please login using your student login (just the username, not the full email) and password. After successfully logging in you will be able to use the browser and any of the learning tools.

You will see links for Canvas, Office365 (for e-mail), and other learning tools your student will be using. To login to each of these tools please use your Lynden school e-mail address and password.

## Support

The Lynden IT team will provide as much support as is possible to ensure the device is working properly. If you have any issues please consult your school Tech Coach or fill out a request for assistance form at [www.LyndenTechSupport.com](http://www.LyndenTechSupport.com) (this form will be available after September 4).

